

INSTALLATION GUIDE

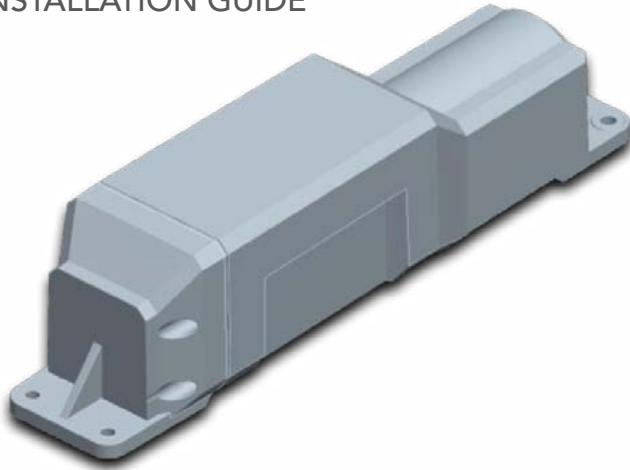

DIMENSIONS:

Length: 252mm (10 inches)
Width: 60mm (2.36 inches)
Height: 62mm (2.44 inches)
Weight: 700 grams (25 ounces)

ENVIRONMENTAL SPECIFICATIONS:

Operating Temperature: -30°C to 75°C
Storage Temperature: -40°C to 85°C
Water Resistance: This device is water resistant pursuant to the IP67 rating. Do not immerse in water.

Getting Started

Kit Contents:

- Tracking device (with internal battery, internal antenna & no external connections)

Mounting hardware:

- Qty 4, #8 self-drilling sheet metal screws or:
- Qty 4, #8 machine bolts (for bolting)
- Qty 4, #8 washers (for bolting)
- Qty 4, #8 lock nuts (for bolting)

Tools Required for Installation:

- Power drill w/ 5/16 driver (for self-tapping) or:
- Ratchet wrench w/ 3/8 socket (for bolting)
- 5/16 wrench (for bolting)

Activating the GPS Device:

The device will be inactive upon delivery. To activate, remove blue tape from the outside of device.

Installing the GPS Device:

This device can be mounted on any surface, preferably an exterior location in a horizontal position with a clear view to the sky.

Battery Information:

This device will generate an Internal Battery Low Voltage Alert when the internal battery charge drops to 3.0VDC. At 3.0VDC, the device can transmit approximately 30 more events before the battery is fully depleted.

The internal battery is not user serviceable. When the battery depletes, the device must be returned to the factory for battery replacement.

Things to consider when selecting the installation location

- Device should be installed label-side down in a horizontal position.
- If a horizontal position is not possible, ensure device is attached to asset with label-side toward asset.
- Top of device should face the sky as much as possible
- Use caution when drilling holes to avoid damage to wiring, electronics, plumbing, etc.
- Protect the device and install it in an area that's safe from impact when the asset is in operation.

LIMITED WARRANTY:

WHO IS COVERED?

Only the purchaser that first activates the GPS product is covered.

WHAT IS COVERED?

The Spireon, Inc. ("Spireon") GPS product you just purchased is warranted to be free from defects in materials and workmanship.

WHAT IS THE WARRANTY PERIOD?

The warranty begins on the date a rate plan is assigned to your Spireon GPS product and lasts for one year, unless you have purchased a two or three year warranty in which case the warranty lasts for the amount of warranty coverage you purchased, which cannot exceed three years. When the warranty on the original product expires, the warranty on any replacement product also expires.

HOW TO OBTAIN WARRANTY SERVICE?

1. Contact the Customer Service Department using the support number located within this installation guide or the authorized reseller from which you purchased the product ("Authorized Reseller"). Provide them with the ESN (Equipment Serial Number) for each product for warranty coverage verification.
2. Upon verification of coverage, all efforts will be made to resolve the issue remotely. If the issue cannot be timely resolved then an RA# will be issued and provided to you by Spireon or the Authorized Reseller via fax, email, or over the phone.
3. If there is an Authorized Reseller, then the Authorized Reseller may provide you with a replacement product and Spireon will replace the Authorized Reseller's inventory.
4. You or the Authorized Reseller must package the product(s) and send to Spireon with the RA# clearly written on the outside of each package (returns without an RA# will be rejected) and ship to:

Spireon Returns

1350 Reynolds Avenue, Suite 121
Irvine, CA 92614

Note: You are responsible for shipping charges to the returns department.

5. Spireon will test all properly returned products to determine if they are defective. If the product is defective Spireon will provide replacement of the defective product(s) and Spireon is responsible for shipping charges back to you or the Authorized Reseller.

WHAT IS EXCLUDED?

Your warranty does not cover:

- Product damage caused by normal wear and tear.
- Product damage caused by tampering, misuse, accident, abuse, neglect, improper installation, misapplication, alteration of any kind, disaster, or defects due to repairs or modifications made by anyone other than Spireon or an authorized service representative of Spireon.
- Physical damage of any nature whatsoever to the Product, including any opening or attempted opening of the Product.
- Reception problems caused by signal conditions or cable or antenna systems outside the product.

WHAT ARE THE WARRANTY LIMITATIONS? TO THE MAXIMUM EXTENT PERMITTED BY APPLICABLE LAW, Spireon DISCLAIMS, AND YOU EXPRESSLY WAIVE, ANY AND ALL OTHER WARRANTIES OR REPRESENTATIONS OF ANY KIND OR NATURE, INCLUDING, BUT NOT LIMITED TO, IMPLIED WARRANTIES OF MERCHANTABILITY AND FITNESS FOR A PARTICULAR PURPOSE. THE TERM OF ANY IMPLIED WARRANTIES THAT CANNOT BE DISCLAIMED UNDER APPLICABLE LAW SHALL BE LIMITED TO THE DURATION OF THE FOREGOING EXPRESS WARRANTY PERIOD. SOME STATES DO NOT ALLOW THE EXCLUSION OF IMPLIED WARRANTIES AND/OR DO NOT ALLOW LIMITATIONS ON THE AMOUNT OF TIME AN IMPLIED WARRANTY LASTS, SO THE ABOVE LIMITATIONS MAY NOT APPLY TO YOU. THIS LIMITED WARRANTY GIVES YOU SPECIFIC LEGAL RIGHTS. YOU MAY HAVE OTHER RIGHTS WHICH VARY FROM STATE TO STATE.

WHAT IS THE LIMITATION OF LIABILITY? This Limited Warranty is solely for the benefit of the purchaser that first activates the GPS product and Spireon, and shall not create or evidence any right in any third party. THE REPAIR OR REPLACEMENT OF THE PRODUCT AS PROVIDED UNDER THIS LIMITED WARRANTY IS THE SOLE AND EXCLUSIVE REMEDY. TO THE MAXIMUM EXTENT PERMITTED BY APPLICABLE LAW, IN NO EVENT SHALL SPIREON BE LIABLE FOR ANY INCIDENTAL, CONSEQUENTIAL, SPECIAL, INDIRECT, PUNITIVE OR EXEMPLARY DAMAGES OR LOST PROFITS WHATSOEVER ARISING OUT OF THE USE OR INABILITY TO USE THE PRODUCT, OR FOR ANY BREACH OF THIS LIMITED WARRANTY OR OTHERWISE, EVEN IF SPIREON HAS BEEN ADVISED OF THE POSSIBILITY OF SUCH DAMAGES OR SUCH DAMAGES COULD REASONABLY HAVE BEEN FORESEEN BY SPIREON. However, some states do not allow the exclusion or limitation of incidental or consequential damages, so the above limitation or exclusion may not apply to you.

PRODUCT WARNING – COMMUNICATION FAILURES ARE NOT COVERED. Your GPS product utilizes cellular telephone and Global Positioning Satellite communication networks in order to provide service. Spireon is not liable for any failure related to these communications networks. Refer to the Subscription Service Agreement for a complete description of the limitations related to the services provided.

This Limited Warranty constitutes the final, complete and exclusive statement of warranty terms, and no other person or entity is authorized to make any other warranties or representations on behalf of Spireon.